

Congratulations on your purchase of a Camera System Package from BIOPAC!

1. Tripod Assembly (for each tripod)

A. Attach Gooseneck to Tripod

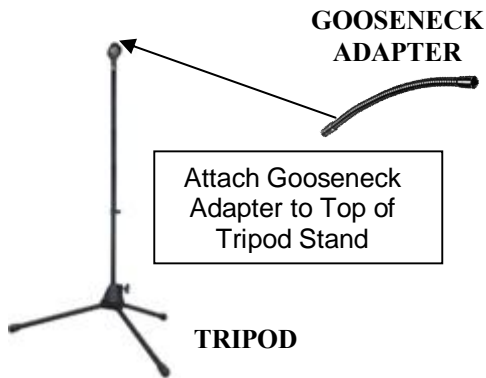

B. Attach Camera to Gooseneck

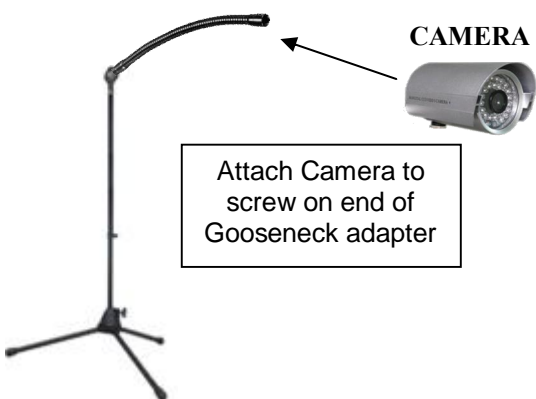

2. Cable Connections (for each camera)

A. Connect End #1 of 18 m Cable to Camera

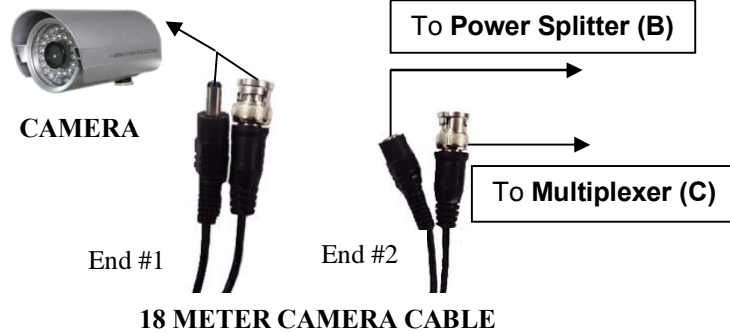

B. Connect Camera and Multiplexer to Power Splitters

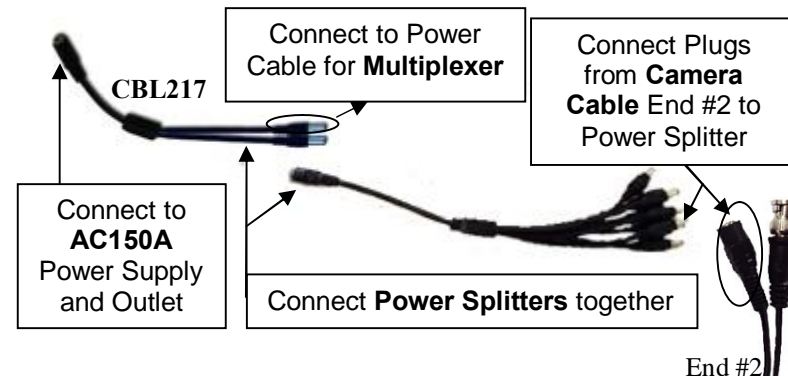

C. Connect End #2 of 18 m Cable to Multiplexer

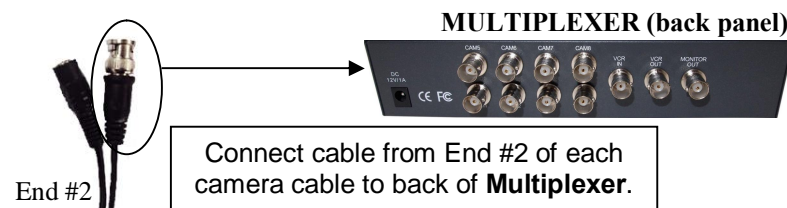

3. Computer Connections

A. Connect Multiplexer and A/D Converter to Computer

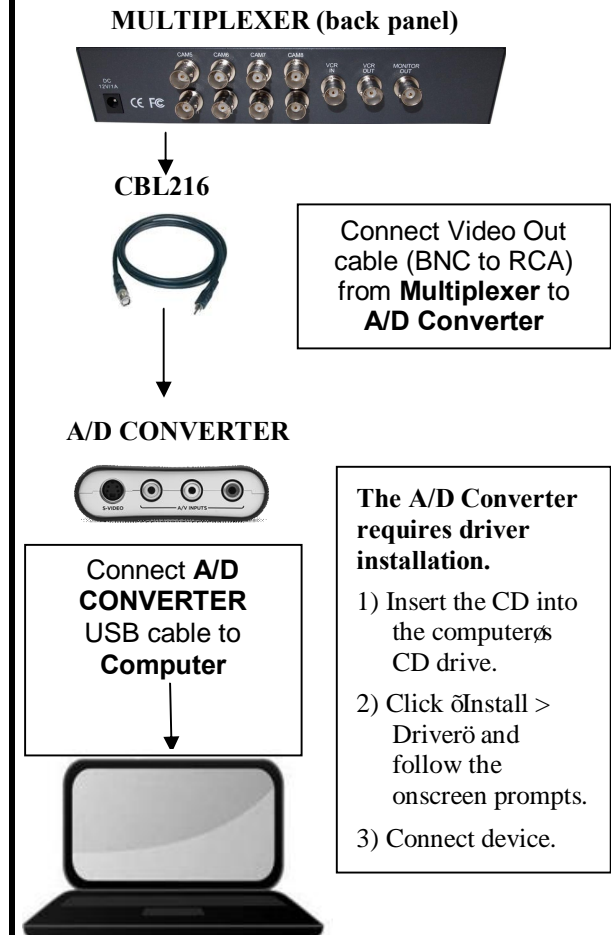

Once Camera System connections are completed, select cameras from the **Media Menu in *AcqKnowledge*. Next, synchronize the cameras with the **MP160 System** using **OUT103** LED light. For more information on synchronization, see Application Note 270 available on BIOPAC online **Support** page.